

Pocket Guide for Installation

Safe-Drive Generation 2.1

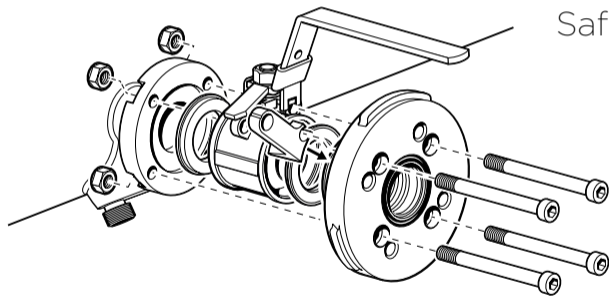

PR-23-SD
SDI2-23-SN2-XS
SDI2-23-WP2-XS
SDI2-23-PL-SS
SDR2-23

VAISALA

IM-EN-SDI21INST-PG
Rev. 2.00

SAFETY REQUIREMENTS



INSTALLATION EQUIPMENT

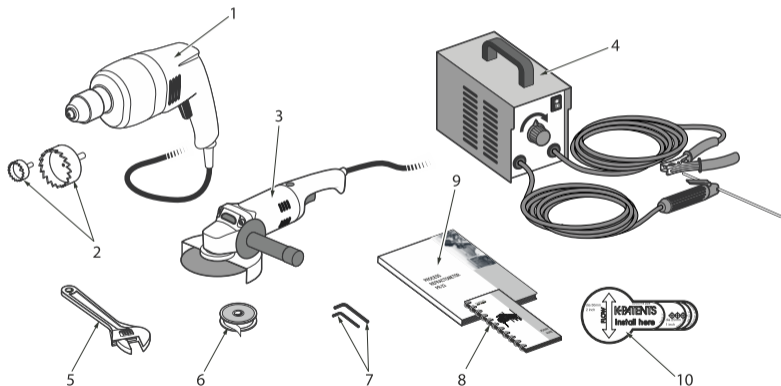

1. Drill
2. Hole saw 1" and 2"
3. Angle grinder
4. Welding machine
5. Adjustable wrench
6. Thread seal tape
7. Allen keys 5 and 8 mm
8. Installation pocket guide
9. Product user manual
10. Drilling guide sticker

SENSOR INSERTION EQUIPMENT

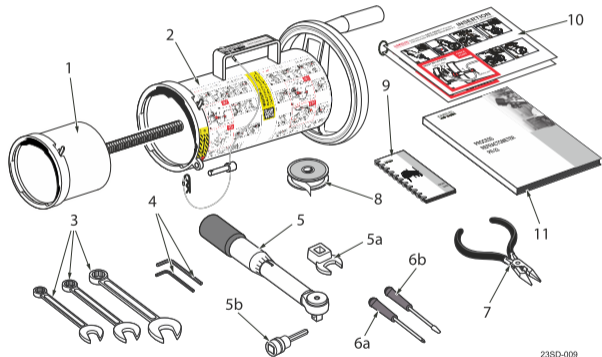

1. Retractor inner casing
2. Retractor outer casing
3. Combination wrenches 32 mm, 14 mm, 8 mm
4. Allen keys 8 mm, 5 mm
5. Torque wrench
 - 5a. open end fitting 19 mm
 - 5b. hex bit socket 8 mm
6. Screwdriver
 - 6a. Phillips head
 - 6b. Flat head
7. Pliers
8. Thread seal tape
9. Pocket guide for insertion and retraction
10. Laminated instruction cards
11. Best Practices document

INSTALLATION LOCATION (horizontal)

Installation on the outside
region of the pipe.

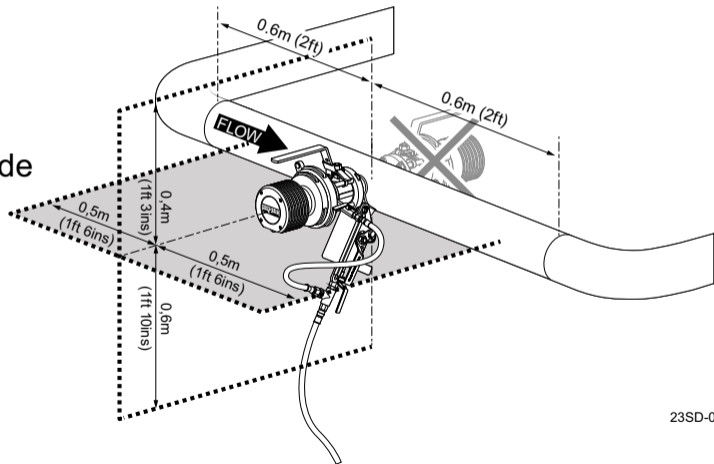

INSTALLATION LOCATION (vertical)

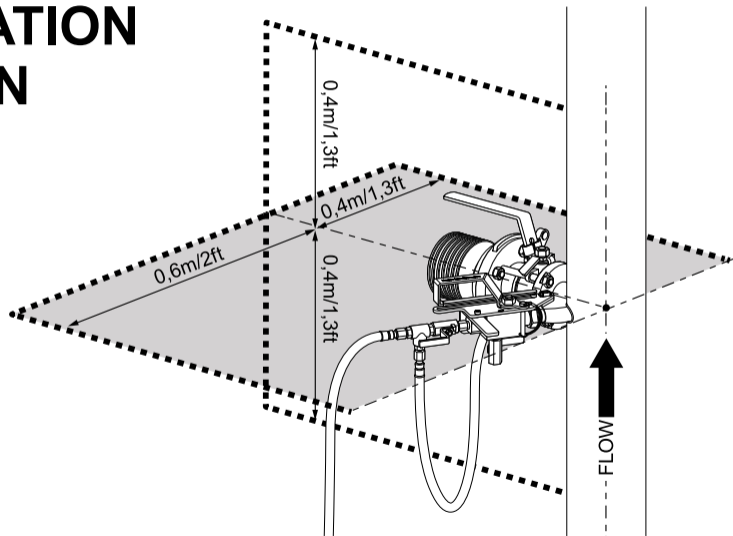

INSTALLING AT HEIGHT

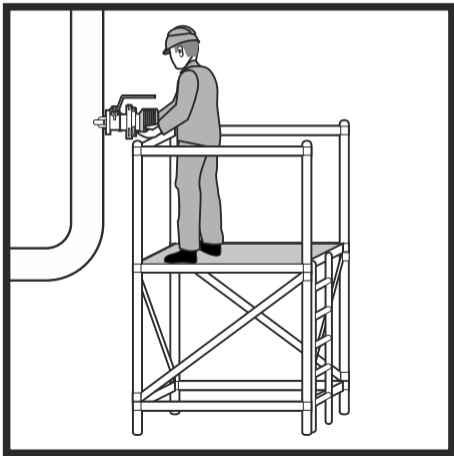
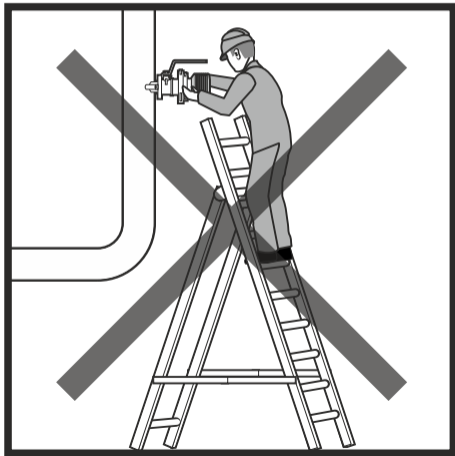

DISASSEMBLY

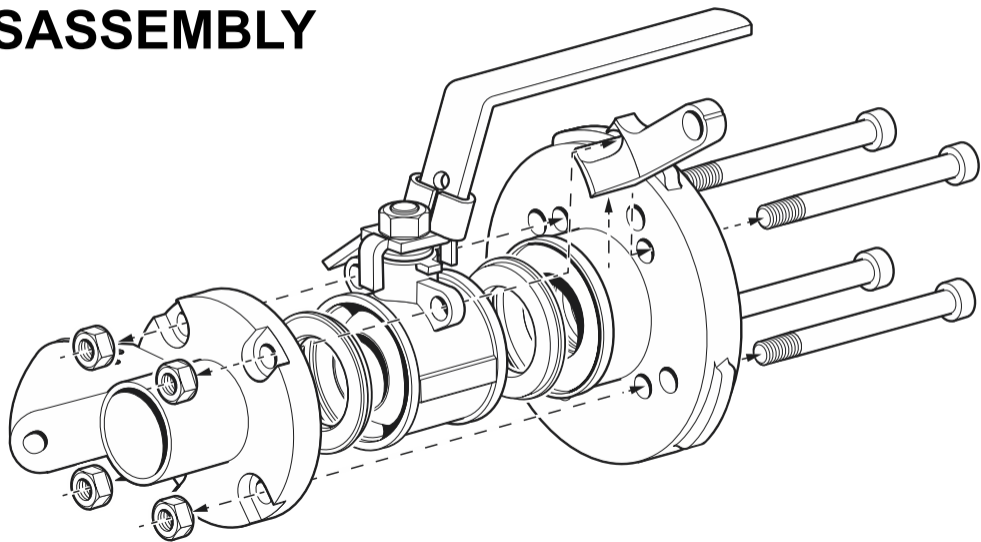

DRILLING (horizontal)

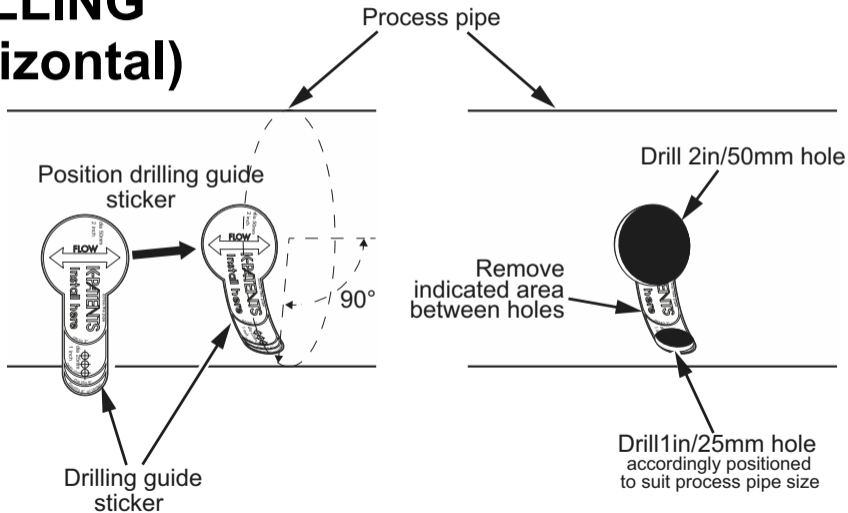

WELDING (horizontal)

Important:
Remove
nozzle
before
welding.

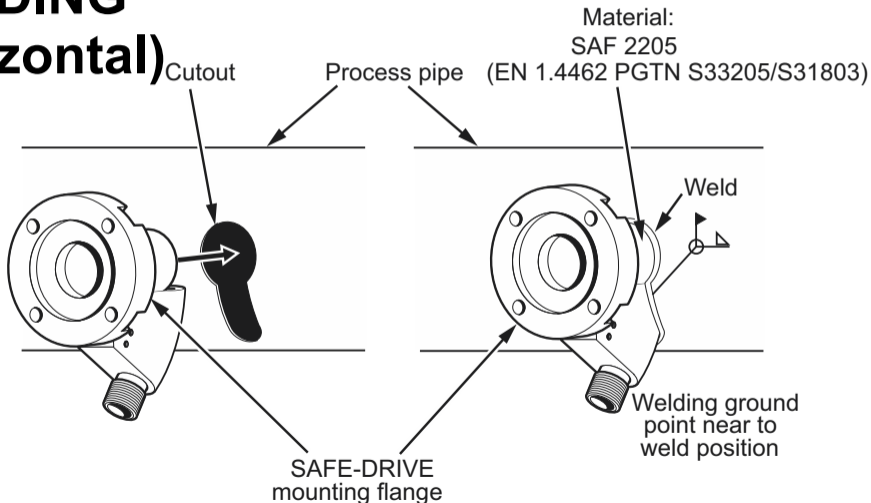

DRILLING (vertical)

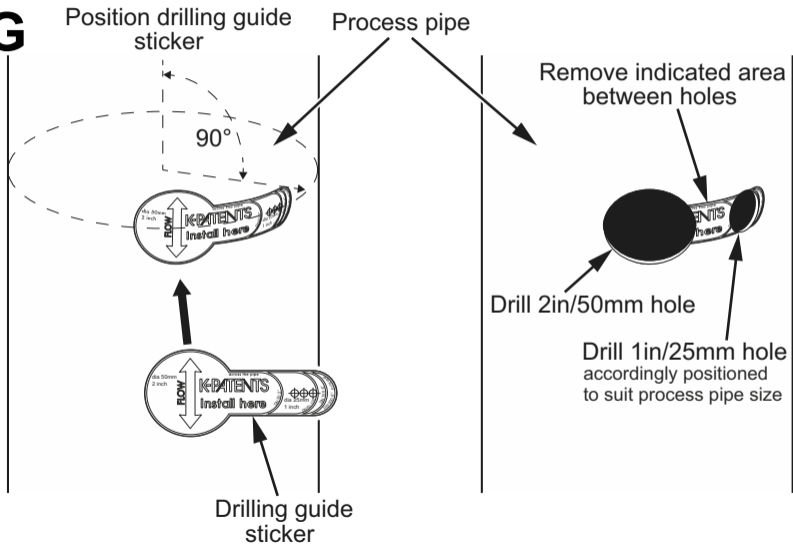

WELDING (vertical)

Important:
Remove nozzle
before welding.

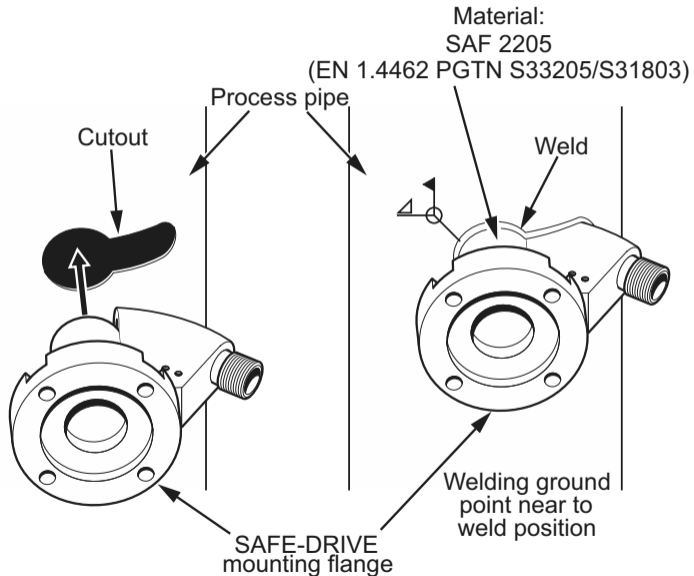

WELDING PLATE

(Brown stock washing fiber line installation)
horizontal, with knife

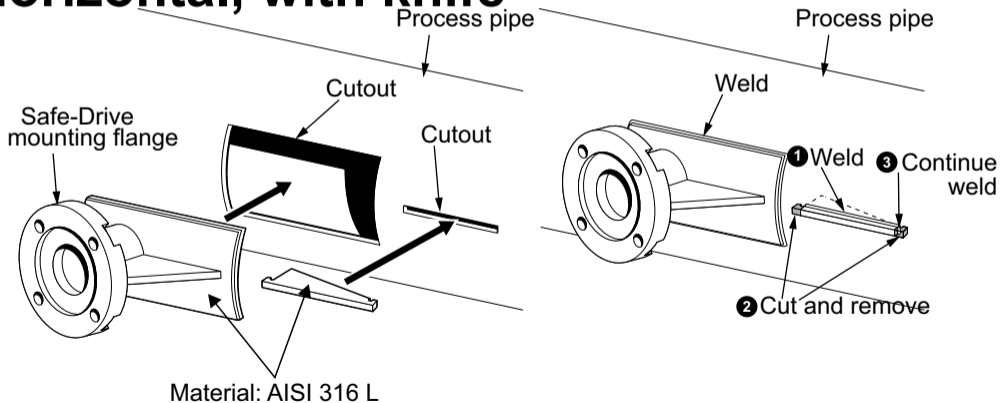

WELDING PLATE

(Brown stock washing fiber line installation)
vertical, with knife

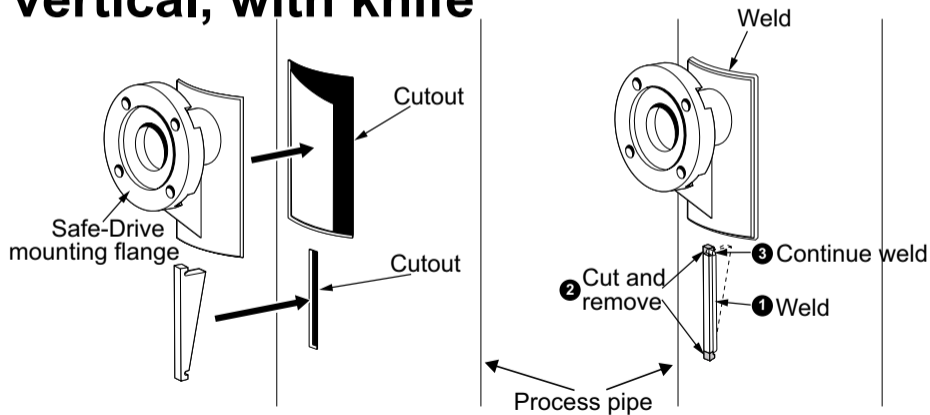

ASSEMBLY (horizontal)

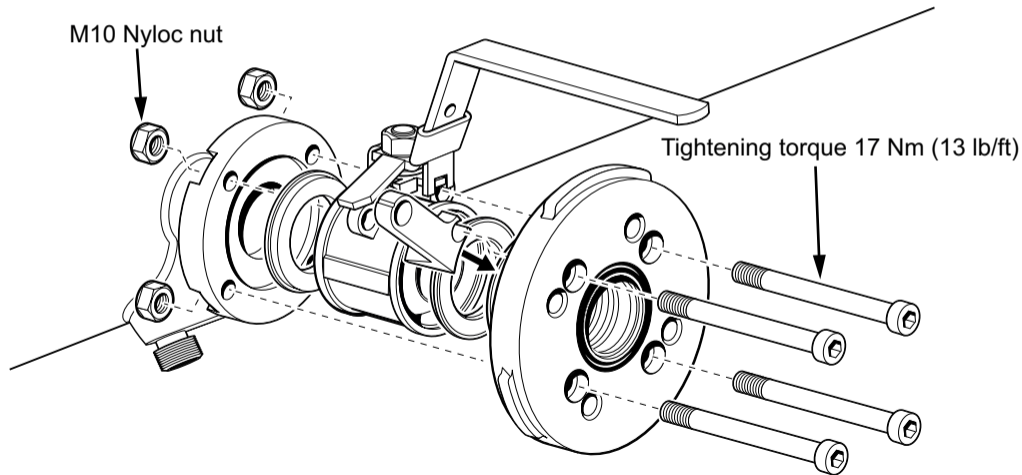

ASSEMBLY (vertical)

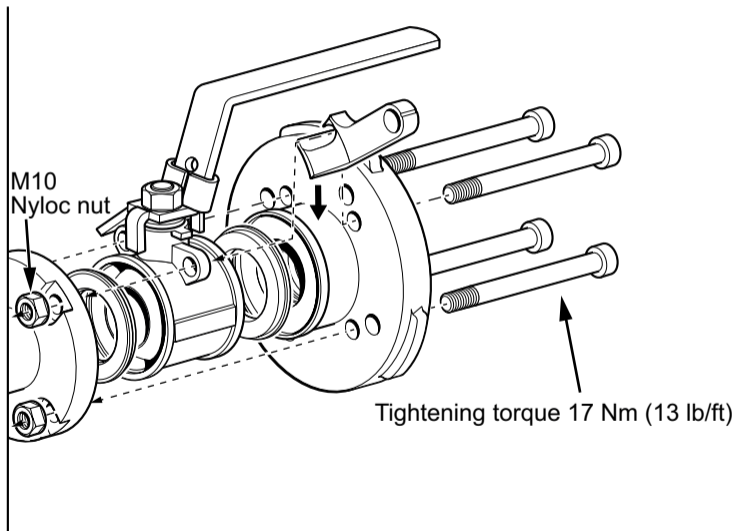

STEAM LINE INSTAL- LATION

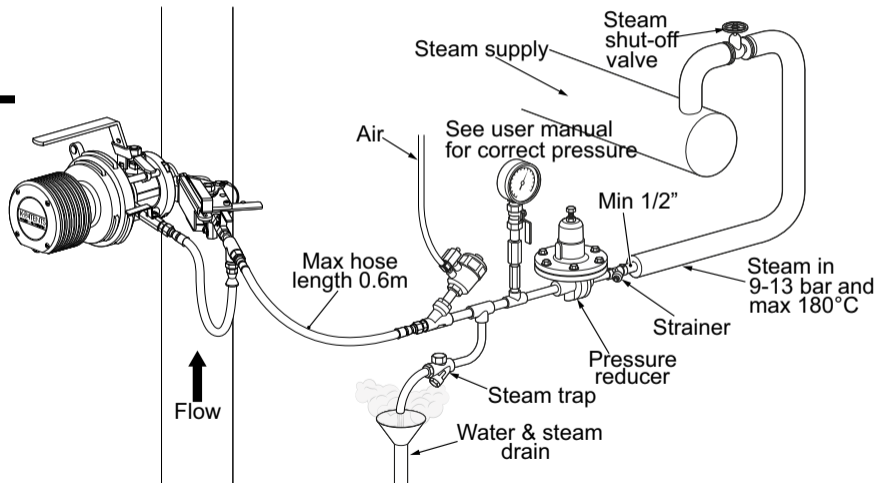

STEAM LINE INSULATION

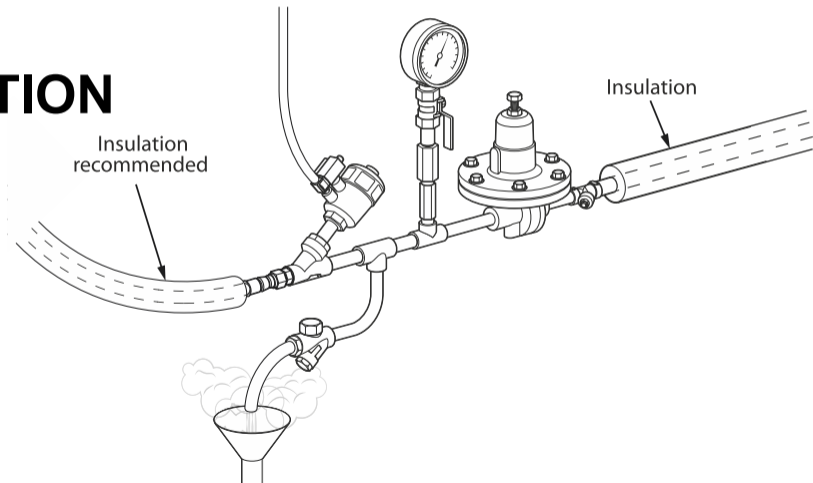

HIGH PRESSURE WATER INSTAL- LATION

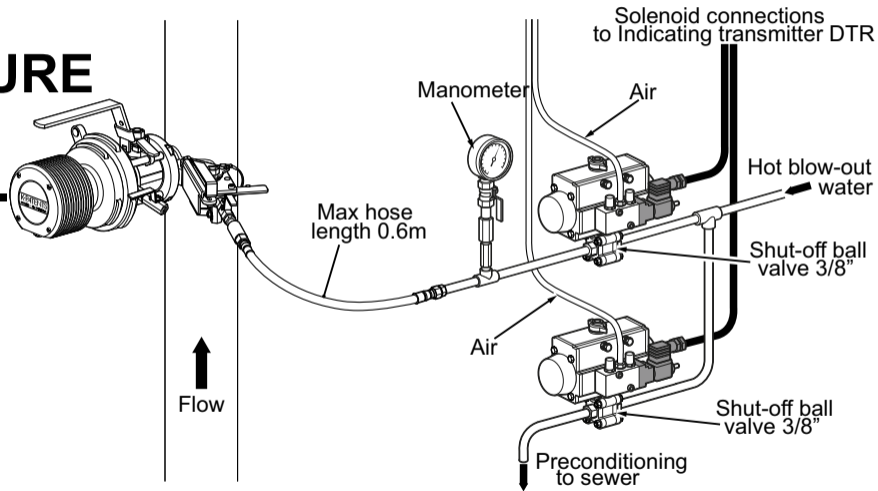

INSULATION

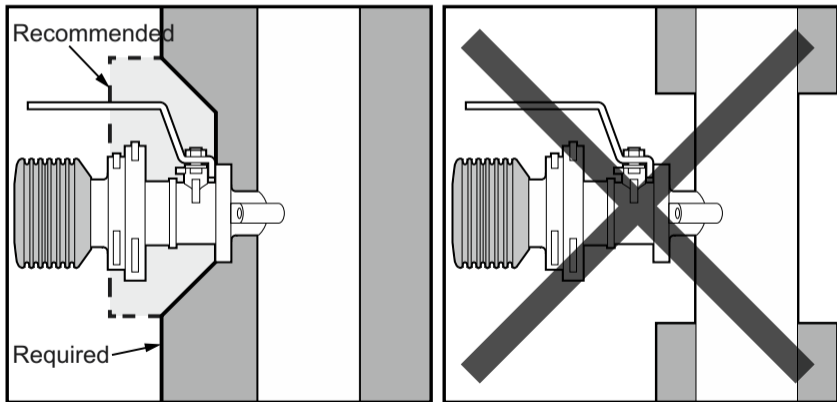

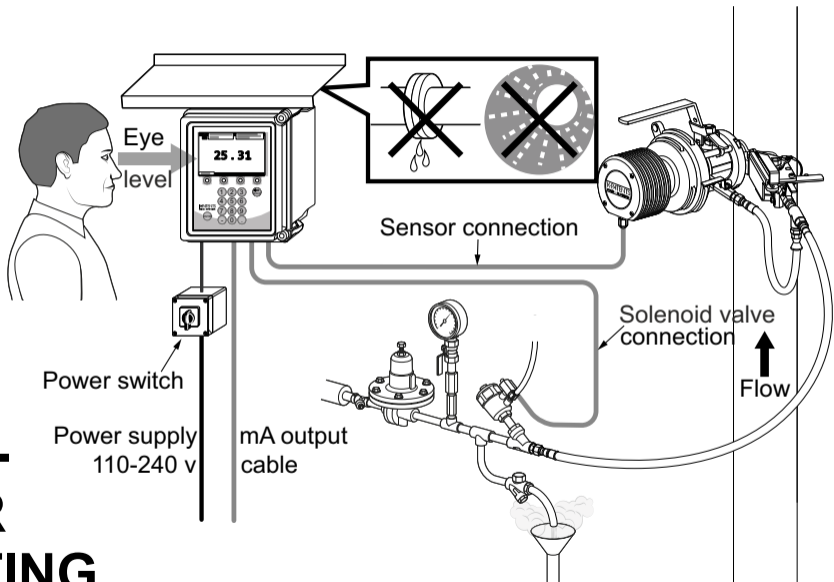

TRANS-MITTER MOUNTING

VAISALA

www.vaisala.com